



Pro-Wire's **Box Buddy®** low voltage mounting rings, with the Snap-Off Alignment Guide, accurately positions low voltage devices next to 110 V electrical boxes. Ensuring standard NEC spacing enables the 110 V and low voltage device(s) to be covered with one multi-gang cover plate for an elegant appearance. Box Buddy's unique pull-off alignment tool makes installation and alignment of 110 VAC and low voltage devices simple and quick. All Box Buddy Mounting Rings are made of ABS flame retardant plastic which is UL 94V-0 compliant.



Pro-Wire's **MR Series of Multi-Gang Mud Rings** are ideal for mounting a wide variety of low-voltage devices. They feature 1" and 2" conduit openings with 5/8" offset, readily enabling unobtrusive use of conduit connectors.



Snap-off alignment tool
Included with each
BB Mud Ring



BB-11

Add 1 Low Voltage device
to a 1 gang 110 VAC Box
Cut Out: 4-1/8" W x 3-11/16" H

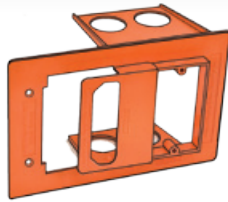

BB-12

Add 2 Low Voltage devices
to a 1 gang 110 VAC Box
Cut Out: 5-15/16" W x 3-11/16" H

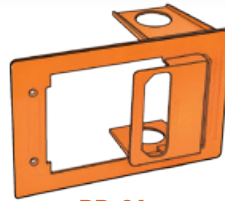

BB-21

Add 1 Low Voltage device
to a 2 gang 110 VAC Box
Cut Out: 5-15/16" W x 3-11/16" H

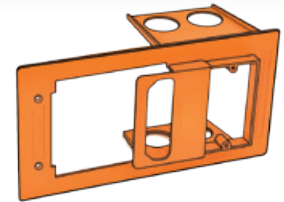

BB-22

Add 2 Low Voltage devices
to a 2 gang 110 VAC Box
Cut Out: 7-3/4" W x 3-11/16" H

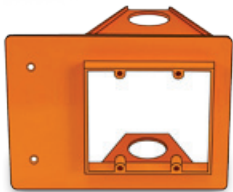

MR-21

2 Gang
1" conduit openings
Cut Out: 4-1/16" W x 3-3/4" H

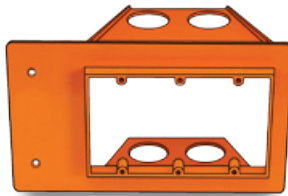

MR-31

3 Gang
1" conduit openings
Cut Out: 5-7/8" W x 3-3/4" H

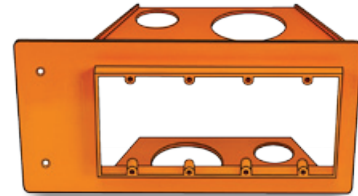

MR-421

4 Gang
1" & 2" conduit openings
Cut Out: 7-5/8" W x 3-11/16" H

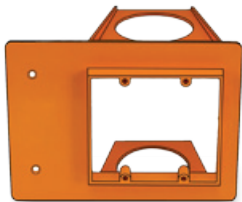

MR-22

2 Gang
2" conduit openings
Cut Out: 4-1/16" W x 3-3/4" H

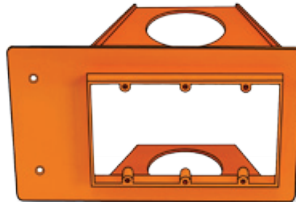

MR-32

3 Gang
2" conduit openings
Cut Out: 5-7/8" W x 3-3/4" H

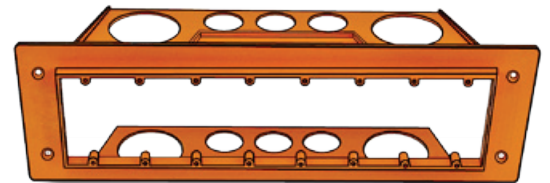

MR-8

8 Gang
1" & 2" conduit openings
Cut Out: 14-3/4" W x 3-3/4" H

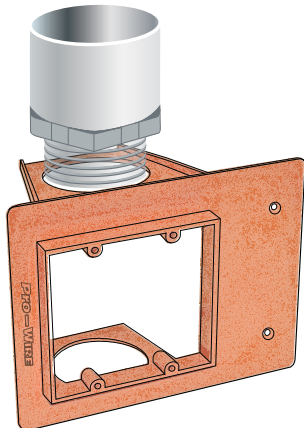

MR-1

Combination Speaker
Locator & Single Gang
Mud Ring
Cut Out: 2-1/4" W x 3-9/16" H

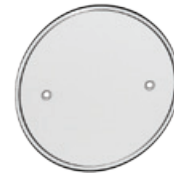

MR-CVR
Round Metal Cover Plate
for the MR-1